

# Sanctuary





# Sanctuary

48m / 9 Cabins / 18 Guests

Embark on the journey of a lifetime through Indonesia's mesmerizing waters aboard this majestic phinisi yacht. This vessel elegantly blends traditional craftsmanship with modern luxury, featuring opulent cabins, spacious decks, and gourmet dining. Enjoy panoramic views, relax on the sun deck, and savor exquisite meals prepared by expert chefs using fresh, locally-sourced ingredients.

Beyond luxurious comforts, the yacht offers unparalleled adventures amidst Indonesia's natural wonders. Dive into vibrant marine life, explore hidden coves and pristine beaches, and trek through lush landscapes. Discover the biodiversity of Raja Ampat, swim with manta rays, and encounter Komodo dragons in their natural habitat. Each day brings new experiences, making this journey an unforgettable voyage through the enchanting Indonesian archipelago.

## Build Specifications

Flag	: Indonesia
Build	: Bulukumba, 2023
Beam	: 10.23m
Length	: 48m
Draft	: 4.17m
Type	: Phinisi Sailing Yacht
Guest	: 18 Pax
Cruise Speed	: 8 Knot
Top Speed	: 11 Knot
Cabins	: 9
Crew	: 18
Navigation	: Garmin Aquamap 1252



# Deck Plan

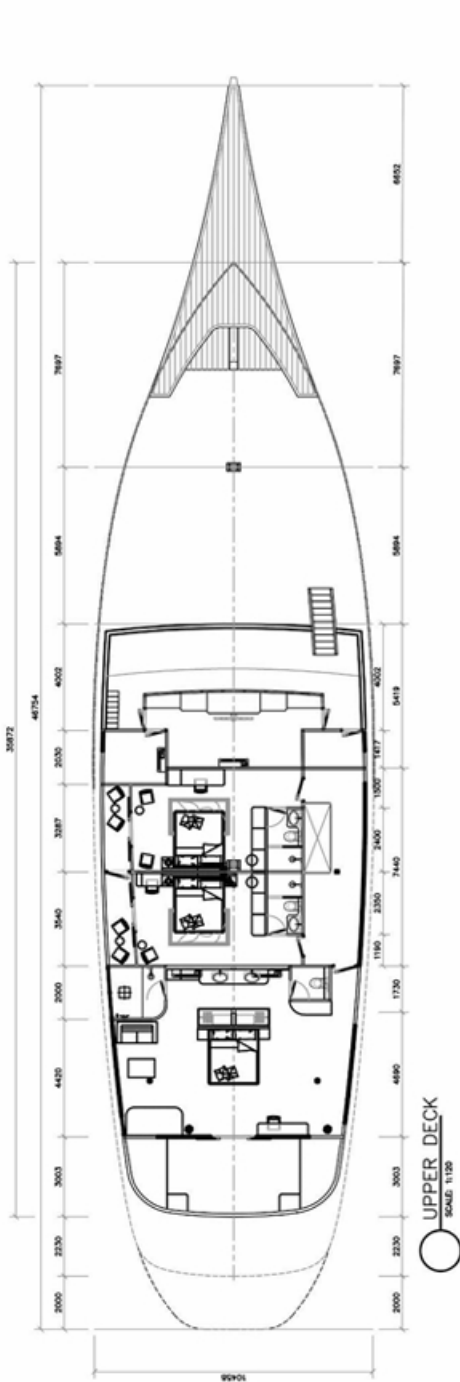

## Upper Deck

Bed & Side Table  
Study Table  
Wardrobe & Make-up Table  
Suitcase Table  
Arm Chair  
Private Balcony  
Bathroom

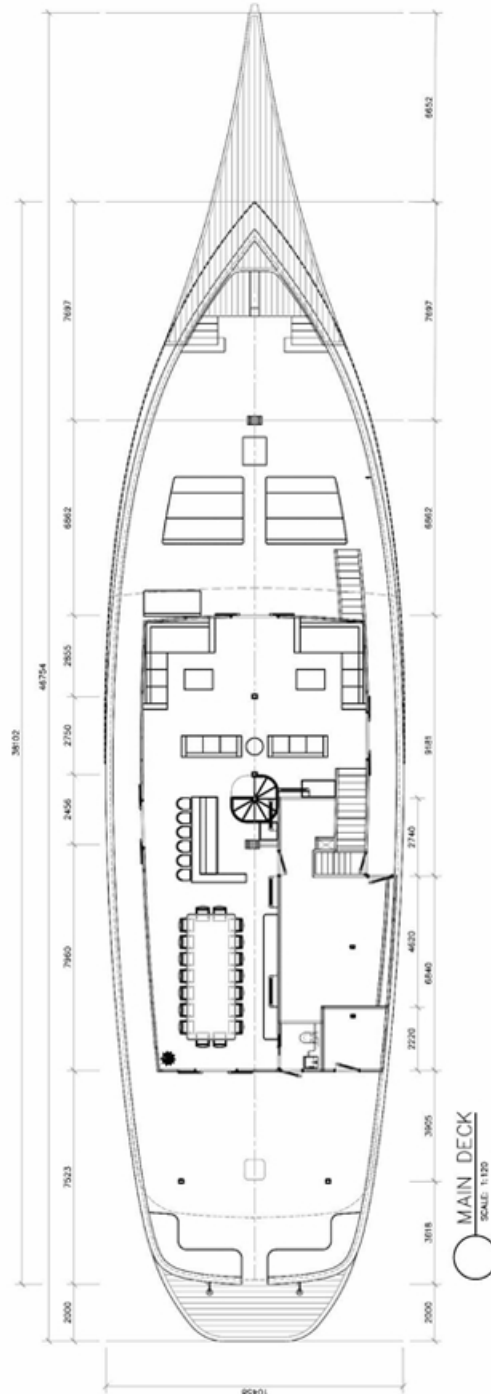

## Main Deck

Coffee Table  
Sofa 3 Seater  
Sofa L-Shaped  
Showcase Chiller  
High Cabinet  
Bar Table  
Dining Table  
Buffet Table

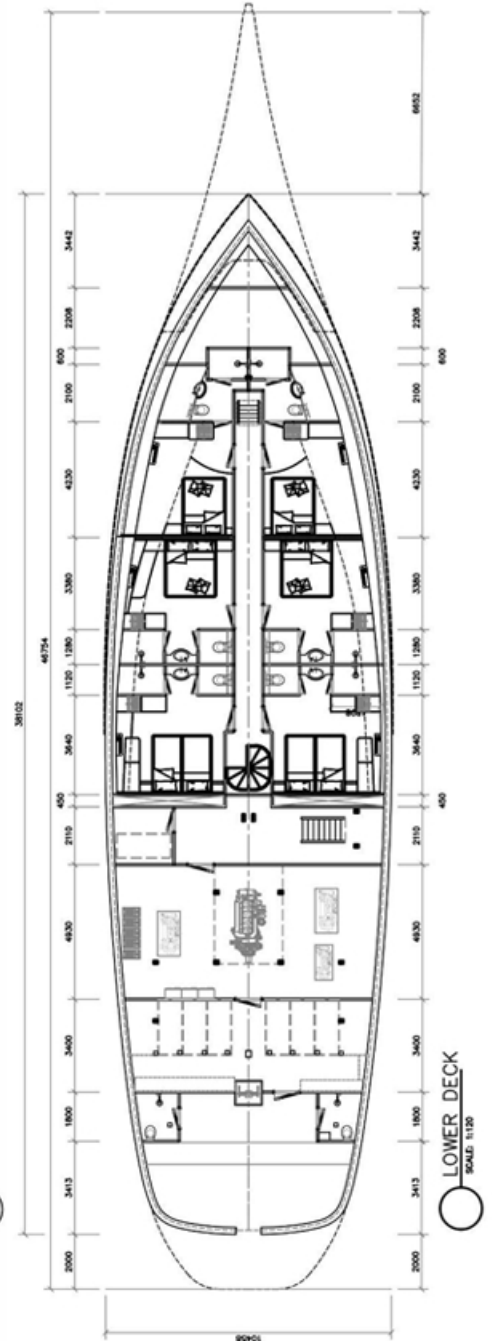

## Lower Deck

Bed & Site Table  
Bench  
Wardrobe  
Bathroom  
Wastafel  
Toilet



## Inclusion

- Crew including Captain, Cruise Director, Dive Instructor, Masseuse
- All gourmet meals and snacks
- Soft drinks and juices
- Personal laundry
- Use of equipment on board: gym (exercise bike, weights, yoga mats), board games, movie library
- Stand up paddleboards
- Wakeboard, Waterski, Sea kayaks
- Snorkeling and Diving equipment (for certified divers)
- 2 tenders (2 RIB x 7M x 100HP)
- All excursions and guide fees
- National Park permits and clearances
- Fuel charges
- Airport transfers

## Exclusion

- International and domestic airfares, excess baggage fees, passports, visas, or airport taxes
- Alcoholic beverages
- Spa and massage treatments
- Personal expenses & crew gratuities
- Travel and diving insurance (mandatory)
- Unscheduled excursions and drone usage fee where applicable
- Service charge for onboard consumption

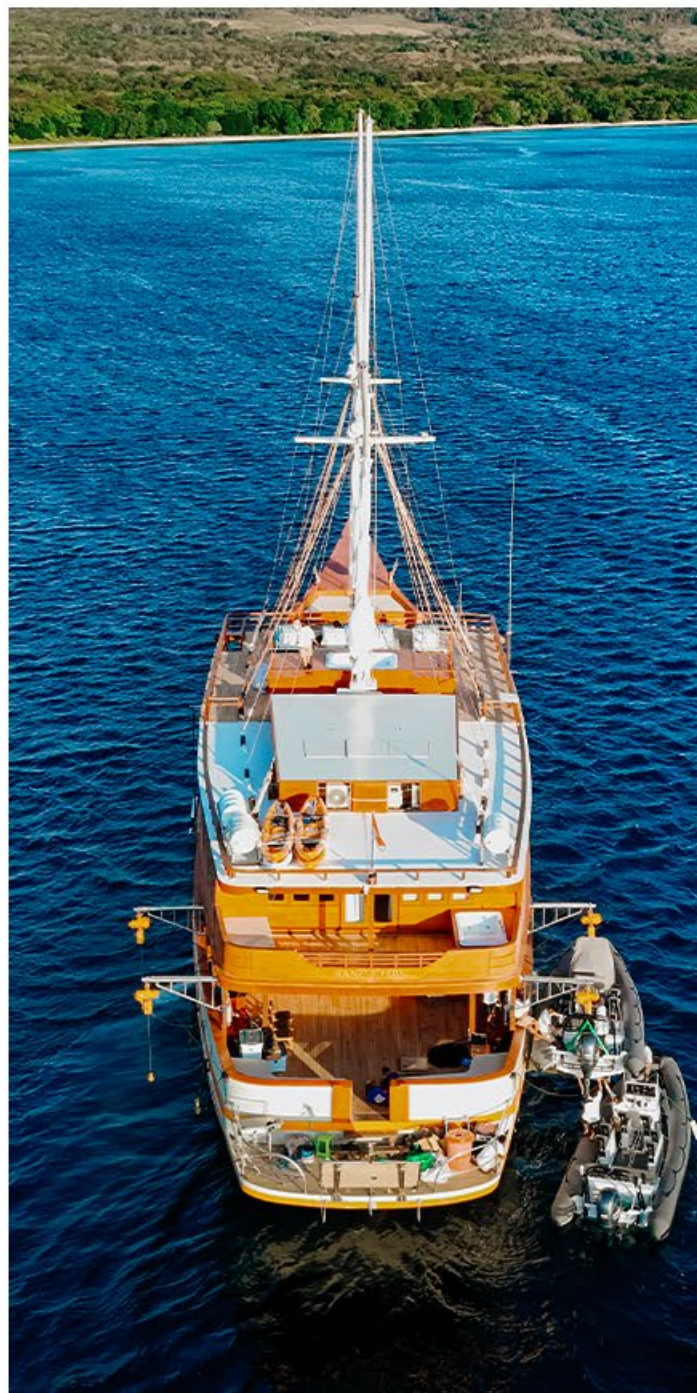



# Sanctuary



Elevating timeless design with a touch of modern elegance, the marriage of aged teak wood, stainless steel, and tinted glass weaves together, resulting in a captivating and seamlessly sleek contemporary masterpiece.



# Exterior

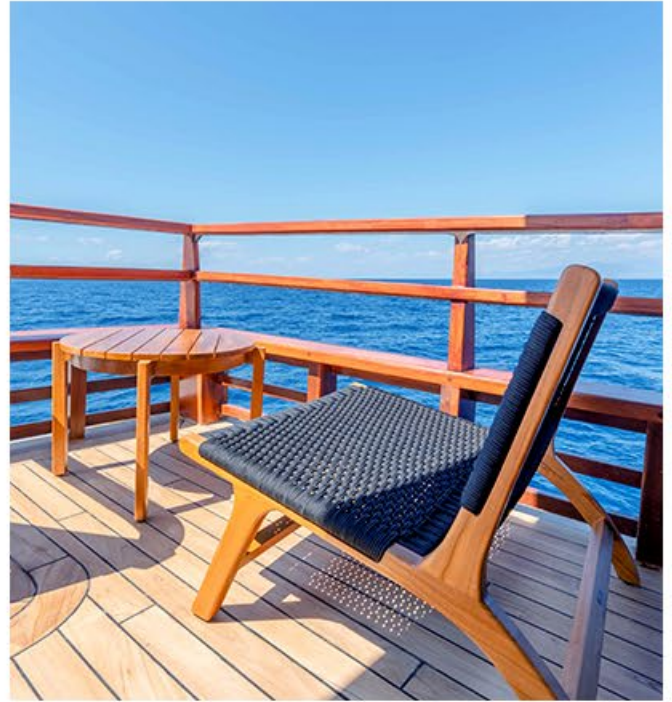

The deck is a sanctuary where opulence gracefully intertwines with the tranquil embrace of open-air serenity, crafting a haven that exudes both extravagance and the soothing essence of nature's embrace.



# Interior



Navigate this serene space, immersed in calmness, designed meticulously for introspection. Every detail crafts a sanctuary, offering solace and a retreat from the external world's demands.



# Cabins

The design of this cabin celebrates the harmonious relationship between architecture and nature. It invites both residents and visitors to connect with the ever-changing beauty of the ocean, fostering a sense of peace and appreciation for the world outside the window.

